



**Arizona Archery Enterprises**  
2781 N. Valley View Drive • Prescott Valley, AZ 86314  
Phone: 928-772-9887 • Fax: 928-772-6287  
[www.arizonaarchery.com](http://www.arizonaarchery.com)

## The Most Accurate Fall-Away Rest in the World!

The **Pro Drop Fall-Away** arrow rest was designed to give bowhunters and target archers perfect vane and feather clearance and ultimate accuracy. Built on AAE's renowned Pro Series frame, the vertical and horizontal micro adjust features make tuning quick and easy and will maintain your tune for years to come.

The Pro Drop Fall-Away arrow rest was designed to give bowhunters and target archers perfect vane and feather clearance and ultimate accuracy. Built on AAE's renowned Pro Series frame, the vertical and horizontal micro adjust features make tuning quick and easy and will maintain your tune for years to come.

**INSTALLATION:** Mount your rest to the side of your bow with the 5/16-24 x 3/4 screw. Be sure the rest is level if using the standard mount. Tighten the mount set screw to lock the rest in place. Next, loosen the set screws in the Pro Series Blade Holder and slide it to the left or right to get your approximate center shot. Minor center shot adjustments can be made later using the horizontal micro adjustment.

**SETTING NOCK HEIGHT:** Now using a bow square set your nock height 1/8" high to even by adjusting the vertical micro adjustment. Loosen the vertical lock screw then turn the vertical adjustment knob to reach the desired height. Re-tighten the vertical lock screw.

**AAE LAUNCH PAD:** The arrow cradle on the launcher pad should be placed near the front edge of the riser.

**ATTACHING THE ACTIVATION CABLE:** Your new Pro Drop Rest uses a no-stretch stainless steel activation cable. It is designed to attach to either the top or bottom limb or either buss cable, depending on desired application. Provided with the rest is AAE's exclusive eZ-Clamp and Limb Sandwich. Both of these attachment accessories are designed to give you easy set-up and ultimate timing adjustability. Some bow and quiver set-ups require the activation cable to attach below the rest. Decide which direction your cable should go. If you need to attach the cable below the rest, see the section called "Rotating the Activation Knob".

### **OPTION 1 - MOUNTING THE LIMB SANDWICH:**

Mount the limb sandwich using the supplied 4-40 socket head cap screws. Be sure to mount the limb sandwich in a position that allows the launcher to travel all the way to its up position. When the rest is fully up the "Stop Screw" should be in contact

with "Up Stop Pin". On some bows that have a large amount of limb flex you will want to move the Limb Sandwich down towards the limb pocket to a point where the limb is flexing just enough to allow for full travel. If the bow has excessive limb over travel damage can occur to the Whale Tail Launcher, so this position will reduce this possibility. The section of the Limb Sandwich that has the set screw goes on the inside of the limb. **DO NOT OVERTIGHTEN THE SCREWS.** Rotate the activation knob till the launcher is in the down position, appx 1/16" off the Launch Pad. Tighten the axle lock screw located under the rest. Feed the activation cable thru the activation cable hole in the Limb Sandwich. Pull the activation cable tight and then Sandwich. Pull the activation cable tight and then tighten down the set screw in the Limb Sandwich. **DO NOT** strip out the Limb Sandwich set screw. Loosen the axle lock screw one (1) full turn.

**OPTION 2 - MOUNTING THE eZ-CLAMP:** The eZ-Clamp will attach to the down buss cable above the rest, or to the up buss cable below the rest. Mount the eZ-Clamp a minimum of 5-inches above or below the rest using the included Plastite screws. The activation cable hole should face the riser of the bow to avoid rotating the cables of the bow when the arrow is released. Rotate the activation knob till the launcher is in the down position appx 1/16" off the Launch Pad. Tighten the axle lock screw located under the rest. Feed the activation cable thru the activation cable hole in the eZ-Clamp. Pull the activation cable tight and then tighten down the set screw in the eZ-Clamp. **DO NOT** strip out the eZ-Clamp set screw. Loosen the axle lock screw one (1) full turn.

**ADJUSTING THE PRO SERIES CAGE:** The Pro Series Cage can be adjusted up and down to allow for proper travel of the Whale Tail Launcher without contacting the cage. Using the supplied 1/16" long hex key loosen the cage screws and move the cage into a position that doesn't contact the Whale Tail Launcher when in the down position but will still provide adequate vane clearance. In the case that you need to move the cage outward to allow for better vane clearance install the included Cage Offset Block using the included 4-40 x 5/8" button head cap screws.

**ROTATING THE ACTIVATION KNOB:** Lock the axle in place by tightening the axle set screw down. Take out the vertical adjustment locking button head



screw. Remove the knob-locking set screw. Then remove the axle button head screw. Slowly remove the activation knob from the axle ensuring not to lose the Pro Drop spring that is located inside the rest. Rotate the activation knob 180° so that it points up and insert the leg of the spring into the down hole in the activation knob. Put the activation knob back on the axle and install the axle button head screw. Lightly tighten down the axle button head screw. Be sure the activation knob

can still rotate without moving the axle.

Rotate the activation knob clockwise until the flat on the axle is visible through the set screw hole that is now on the top side of the activation knob. Hold the activation knob in place and install the knob locking set screw. Then tighten down the set screw followed by the axle button head screw. Re-install the vertical adjustment locking button head screw.

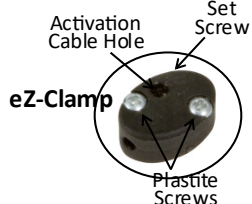
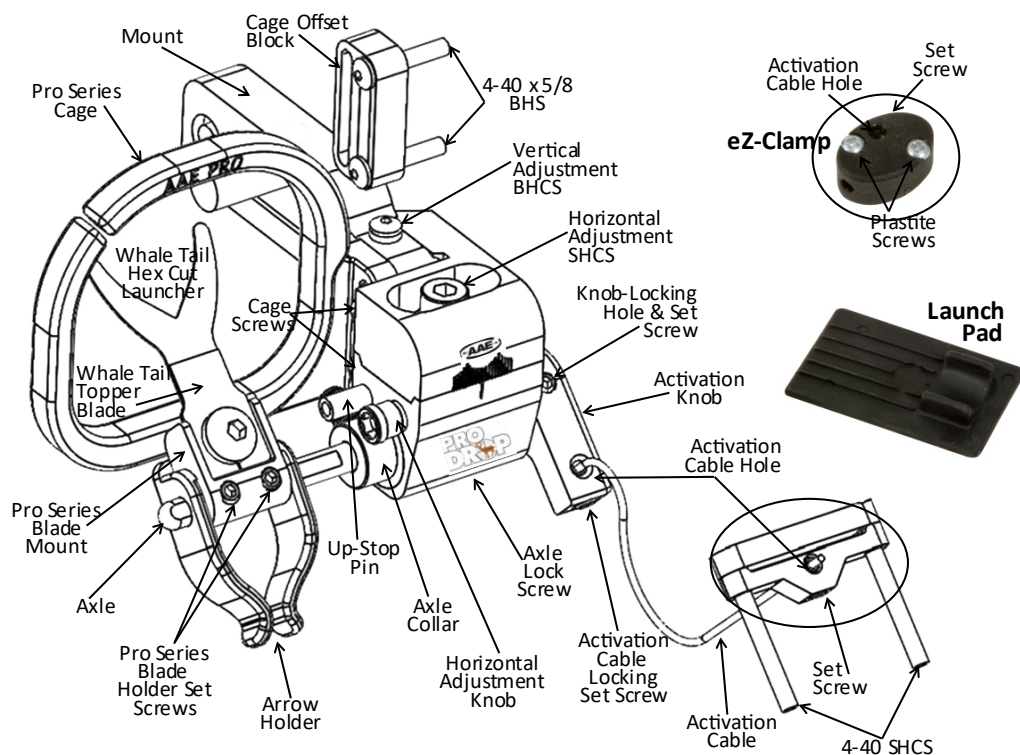

#### SIDE NOTE:

One of the advantages of the Pro Series Blade Holder is the ability to swap out the Hex Cut Whale tail launcher for one of AAE's Pro Series snake tongue blades. Simply remove the activation cord from the rest/bow and tighten down the axle lock screw. Then install the Pro Series Short blade of your choice. Using the Short Blades will maintain your nock height and tune.

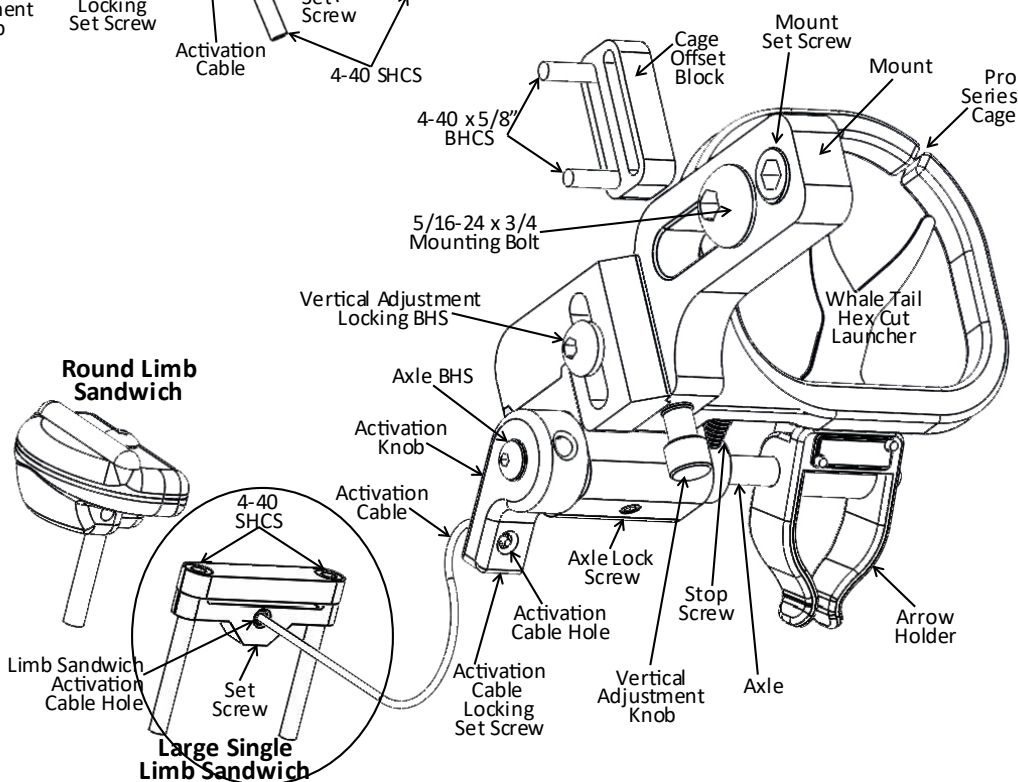

## Arizona Archery Enterprises

2781 N. Valley View Drive • Prescott Valley, AZ 86314

Phone: 928-772-9887 • Fax: 928-772-6287

www.arizonaarchery.com